

DRAWING NO. XRL-L03

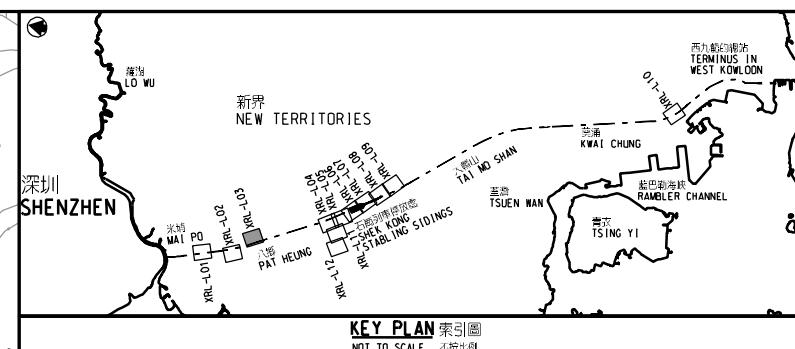
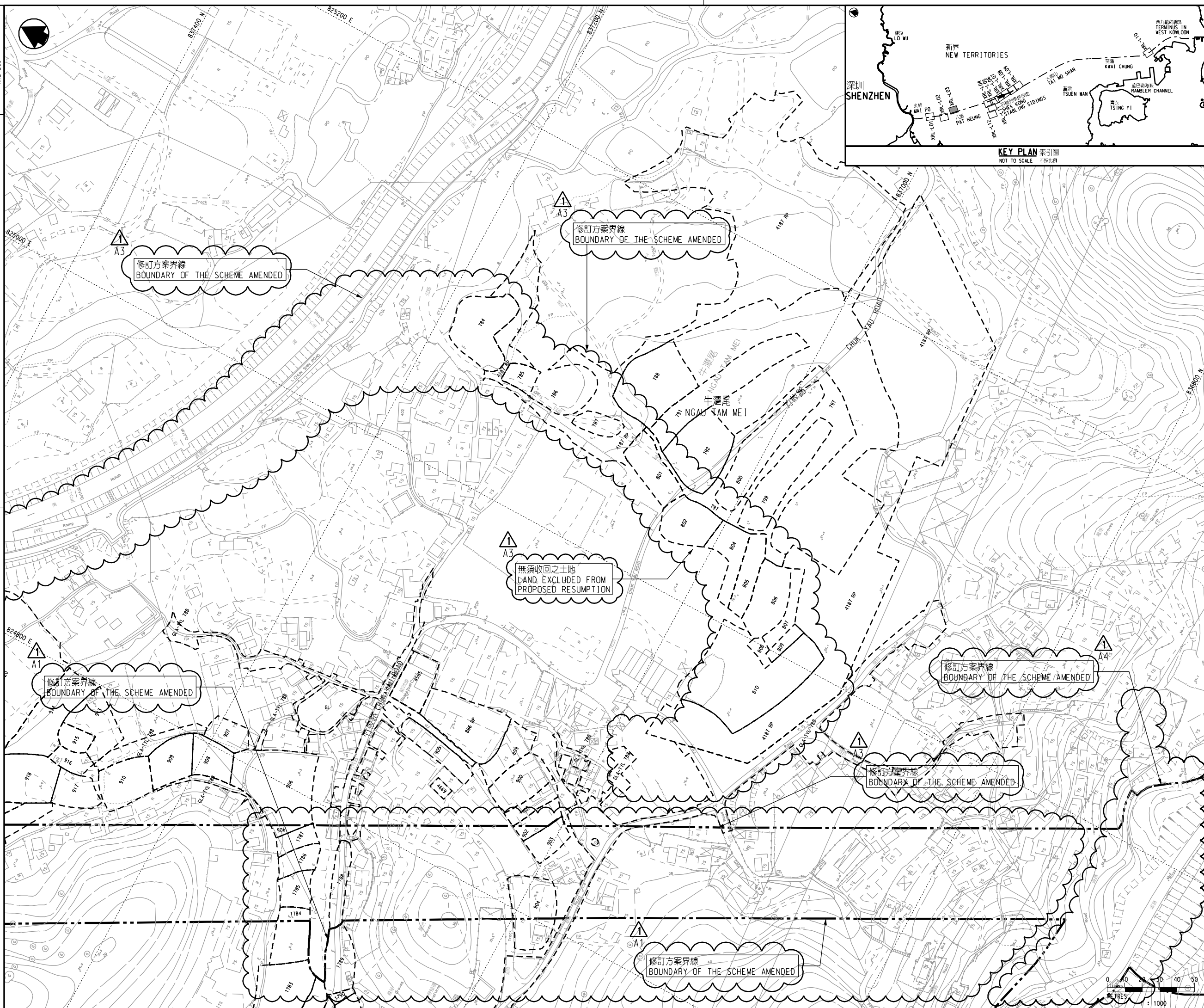

圖例 LEGEND

- 方案界線
BOUNDARY OF THE SCHEME
- - - 地段界線
LOT BOUNDARY
- • • 丈量約份界線
DEMARICATION DISTRICT BOUNDARY
- ▨ 建議將予收回的農地
AGRICULTURAL LAND PROPOSED TO BE RESUMED
- ▧ 建議將予收回的屋地
BUILDING LAND PROPOSED TO BE RESUMED
- ▩ 建議將予收回的其他土地
OTHER LAND PROPOSED TO BE RESUMED
- DD 丈量約份
DEMARICATION DISTRICT
- GL 政府土地
GOVERNMENT LAND
- RP 餘段
REMAINING PORTION
- S. 分段
SECTION
- SS. 小分段
SUB-SECTION
- (P) 部分
PORTION
- NK IL 新九龍內地段
NEW KOWLOON INLAND LOT
- * 混合用地 (農地及屋地)
MIXED LAND (AGRICULTURAL LAND AND BUILDING LAND)
- △ 圖則修改
DRAWING REVISION
- A1 修訂參考編號 (參考憲報公告)
AMENDMENT REFERENCE NUMBER (SEE GAZETTE NOTICE)
- ☁ 修訂範圍
AMENDMENT AREA

一般說明 GENERAL NOTES

- 有關一般說明參閱圖號 XRL-G01.
FOR GENERAL NOTES, REFER TO DRAWING NO. XRL-G01.
- 有關收地面積表參閱圖號 XRL-L13 至 XRL-L14.
FOR RESUMPTION AREA SCHEDULE, REFER TO DRAWING NO. XRL-L13 TO XRL-L14.

修訂表
TABLE OF AMENDMENTS

修訂日期	繪圖	核對	說明	
REV	DATE	BY	DESCRIPTION	
17 APR 2009	CADD	HW/DW	PP	修訂項目 A1, A3 及 A4 AMENDMENT ITEMS A1, A3 AND A4

獲准發出
APPROVED FOR ISSUE

路政署
鐵路發展處處長 (2)
GOVERNMENT ENGINEER/
RAILWAY DEVELOPMENT (2)
HIGHWAYS DEPARTMENT

發出日期 DATE OF ISSUE

圖則名稱 DRAWING TITLE
**廣深港高速鐵路香港段
 鐵路條例(第519章)
 收回土地圖則 14頁的第3頁**
 HONG KONG SECTION OF
 GUANGZHOU - SHENZHEN - HONG KONG
 EXPRESS RAIL LINK
 RAILWAYS ORDINANCE (CHAPTER 519)
 LAND RESUMPTION PLAN
 SHEET 3 OF 14

圖號 DRAWING NO.
XRL - L03

比例 SCALE
 1:1000 (A1)
 或如顯示
 AS SHOWN

香港特別行政區政府
 THE GOVERNMENT OF THE HONG KONG
 SPECIAL ADMINISTRATIVE REGION

路政署
 HIGHWAYS DEPARTMENT

鐵路拓展處
 RAILWAY DEVELOPMENT OFFICE

